

4. Initial Web Access

You can access H640RW through a web browser by using the **initial LAN IP** at first. The detail procedure is as follows:

- ① Connect **LAN1** port of H640RW to your PC using Ethernet cable.
- ② Configure an IP address of your PC to **192.168.1.1~254** (except 192.168.1.100).
- ③ Open a web browser, and enter **http://192.168.1.100:8080** in a URL field.
- ④ Type **“user/user”** in user name/password field, and log into the system. Initial page is displayed.

TIP for Better Wireless Communication

You can make antennas oblique outside or inside the body by tilting(●) and rotating(●) them for better wireless communication as like the figure below.

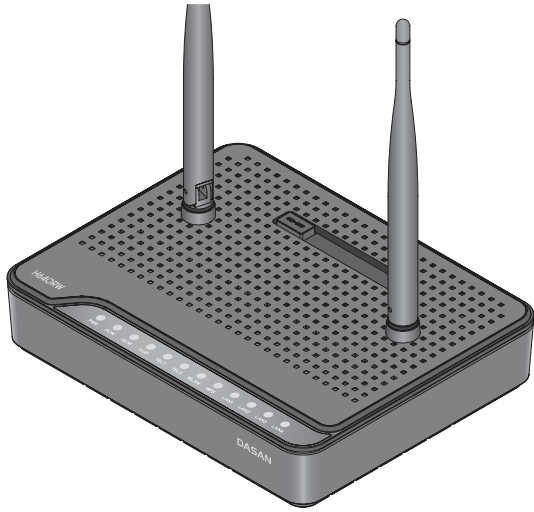
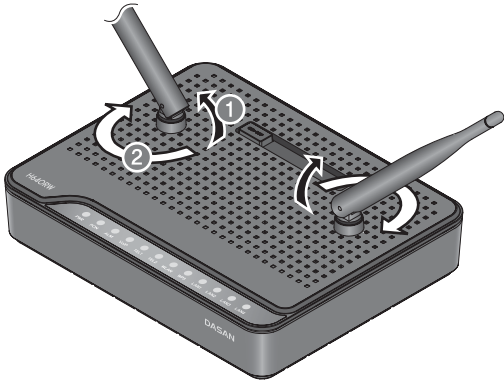

H640RW  
QIG (Quick Guide)

V2

GPON Optical Network Terminal (ONT) with VoIP & Video & Wi-Fi

Information furnished by Dasan Networks, Inc. is believed to be accurate and reliable. However, no responsibility is assumed by Dasan Networks for its use, nor for any infringements of patents or other rights of third parties which may result from its use. No license is granted by implication or otherwise under any patent or patent rights of DASAN Networks. DASAN Networks reserves the rights to change specifications at any time without notice.  
Copyright © 2013 by DASAN Networks, Inc. All rights reserved.

DASAN Networks, Inc.

www.dasannetworks.com

1. Caution

Please follow the instructions below to avoid physical injury:  
You should not install the unit during a storm. Likewise you should not connect or disconnect any line to avoid the risk of electric shock.  
Lay the cables so that no one can step on them or trip over them.  
This section lists important information that will help you to get proper use of this unit and accessories. Please read the following instructions carefully before installing and operating your unit.

Caution & Warning

- This unit is indoor use and all the communication wirings are limited to inside of the building.
- DO NOT plug in, turn on or attempt to operate an obviously damaged unit.
- Never look directly at the fiber TX port and fiber cable ends when they are powered on.
- DO NOT use near water.
- DO NOT place near high temperature source.
- DO NOT disassemble the unit.
- DO NOT operate the unit in a location where the maximum ambient temperature exceeds 104°F (40°C).
- Open optical connections must use a protective cap under all circumstances to protect against physical damage and dirt.
- Before making connections, use isopropyl alcohol and non-fibrous cellulose to clean the faces of the connectors.
- Avoid impact stresses when handling connectors. Physical damage to the faces of optical connections impairs transmission quality (higher attenuation).
- Avoid a bend radius in excess of 1.18 in (30 mm) for fiber optic links.
- Check the available voltage supply.
- Only use the unit in dry rooms.
- Set up the unit away from direct sunlight or other electrical equipment.
- Only connect approved accessories.
- It may only be repaired by authorized service personnel.

- 1 -

2. Introduction

2.1 Package Contents

- H640RW
- RJ45 UTP Cable
- Power Adapter
- QIG (Quick Guide)

2.2 Specification

| Item                   | Specification  |
|------------------------|--|
| System Memory          | 128MB DDR3   |
| Flash Memory           | 128MB Nand Flash   |
| Uplink Interface       | 1 GPON port (SC/APC)   |
| Service Interface      | 4 10/100/1000Base-T ports (RJ45)   |
| VoIP Interface         | 2 FXS ports (RJ11)   |
| Video Interface        | 1 RF Video port (F-connector, coax)  |
| Wireless               | IEEE 802.11b/g/n compliant<br>Bandwidth: 2.4GHz<br>Two Transmit and Two Receive path (2T2R)<br>Max. data rate: 54Mbps in 802.11g<br>300Mbps in 802.11n<br>Security: WEP, WPA-PSK (TKIP) & WPA2-PSK (AES) |
| LED                    | PWR, PON, ALM, VoIP, TEL1~2, WLAN, WPS*, LAN1~4  |
| Power                  | AC/DC Adapter: 12VDC/2A  |
| Operating Temp.        | 32 to 104°F (0 to 40°C)  |
| Humidity               | 5 to 90% (non-condensing)  |
| Dimensions (W x D x H) | 7.48 x 5.90 x 2.44 in (190 x 150 x 62 mm)<br>(including folded antenna)  |
| Button                 | On/Off power, WLAN, WPS*, RESET  |

\* Wi-Fi Protected Setup, a standard that attempts to automate secure wireless network set up and connection

- 2 -

2.3 Front View (LEDs)



| Label             | Light  | Status | Description   |
|-------------------|--------|--------|---|
| PWR               | Green  | On     | The system is turned on.  |
|                   |        | Off    | The system is turned off.   |
| PON               | Green  | On     | Register OK. The GPON port link is up.                                |
|                   |        | Off    | Not registered. The GPON port link is down.                           |
| ALM               | Red    | On     | No optical signal   |
|                   |        | Off    | Optical signal detected   |
| VoIP              | Green  | On     | Register OK   |
|                   |        | Off    | Not registered  |
| TEL 1~2           | Green  | On     | Off-hook  |
|                   |        | Off    | On-hook   |
| WLAN              | Green  | On     | Wireless function enabled   |
|                   |        | Off    | Wireless function disabled  |
| WPS               | Green  | Blink  | In progress   |
|                   |        | On     | Success (for 5 seconds)   |
|                   |        | Off    | Disabled or process finished  |
|                   |        | On     | The 1G port link is up.   |
| LAN 1~4 (LNK/ACT) | Green  | Blink  | The 1G transmit or receive activity is present on the service port.   |
|                   |        | On     | The 100M port link is up.   |
|                   | Orange | Blink  | The 100M transmit or receive activity is present on the service port. |
|                   |        | Off    | Link down   |

- 3 -

2.4 Rear View

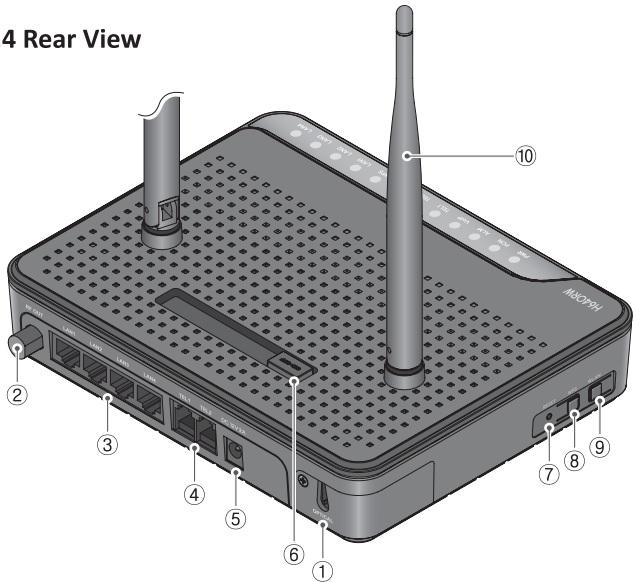

| Item          | Description                            |
|---------------|--|
| ① OPTICAL     | Connect the network.                   |
| ② F-Connector | Connect TV.                            |
| ③ LAN1~4      | Connect PC or LAN.                     |
| ④ TEL1~2      | Connect telephone.                     |
| ⑤ POWER       | Connect power adapter.                 |
| ⑥ ON/OFF      | Turn on/off the unit.                  |
| ⑦ RESET       | Reboot the unit.                       |
| ⑧ WPS         | Enable WPS process.                    |
| ⑨ WLAN        | Enable wireless function.              |
| ⑩ Antenna     | Transmit and receive wireless packets. |

- 4 -

3. Installation

3.1 Connecting to Network (through GPON port)

- ① Loosen the screw from the optic cover.
- ② Pull the optic cover out from the body.
- ③ Remove the cap from GPON port.

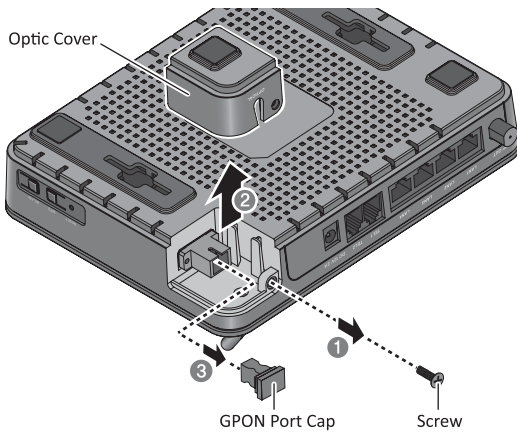

- ④ Plug in the optic cable (SC/APC-connectorized) to connect the ONT to the network (OLT).
- ⑤ Attach the optic cover to the unit.

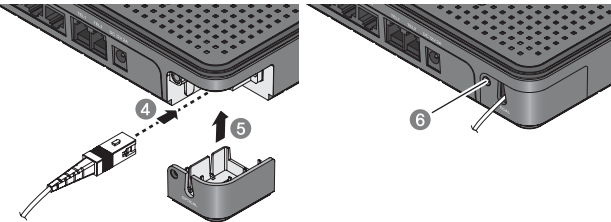

- ⑥ Tighten the screw on the optic cover.

- 5 -

3.2 Mounting on a Wall

If necessary, you may have your ONT mounted on a wall using mounting groove and proper screws or nails.

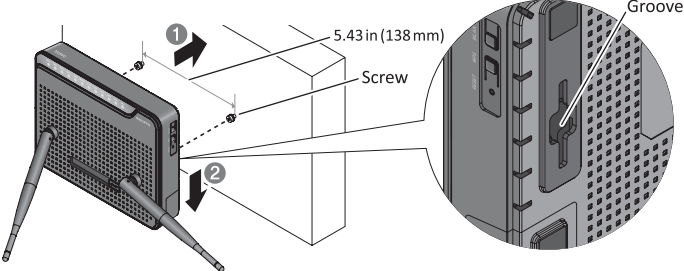

3.3 Connecting Video/Ethernet/VoIP/Power & Enabling WLAN

- ① Connect a coaxial cable from RF OUT port to TV.
- ② Plug the Ethernet cable from LAN port to PC.
- ③ Plug the phone cable from TEL port to telephone.
- ④ Connect the power adapter from power port to a live AC outlet.
- ⑤ Turn on the unit by pushing the power switch.
- ⑥ Push WLAN button to enable WLAN.
- ⑦ Adjust antenna direction for better wireless communication.  
For information of how to adjust the antenna, see **TIP** on the last page.

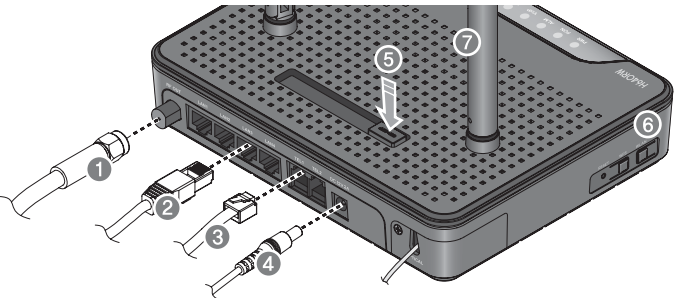

- 6 -